

# Digital Motor Protection Relay

Samwha DSP Ltd.

## DSP-3SD, 3SD-RG Panel Mounting Type Wire Through Type



### Main Features

- Access restricted to authorized operator : Password
- Compact size, Multi-function
  - \*Protection :
    - ▶ Over current/Under current/Phase loss/Reverse phase/Locked rotor/  
Current unbalance : 3SD,3SD-RG
    - ▶ Ground fault : 3SD-RG
  - \*Indication : Current/L1, L2, L3/Earth current
- To cover a wide and precise current range for the protection
  - \*10 Type
    - ▶ Definite T-I : 0.5A~10A, 0.5A~6A with external CT
    - ▶ Inverse T-I : 0.5A~6A/800% to "oc"
  - \*60 Type
    - ▶ Definite T-I : 5A~60A
    - ▶ Inverse T-I : 5A~15A/800% to "oc"
  - \*Extended protection current range with external CT : 1A~600A → 3SD Type
- Display for trip cause and operation information in character and/or number : 4 Digit Window
- Rotated indication for each phase current with 3 sec interval
  - \*1P(single phase) : L1-L3 current \*3P(three phase) : L1-L2-L3
- Ground fault protection based on residual zero phase current:0.5A~10A(not suitable for external CT application) : 0.5A~10A → 3SD-RG Type
- Various trip reset options: Manual, Electrical or Automatic / flexible for automated and sequence machine operation.
- Stable operation under frequency variation from Inverter : 30Hz ~ 400Hz
- Possible to check and/or to change(optional condition) preset value during the operation
- Self-diagnostic test by one touch for "SET" key
- History of latest 8 trip events

## Application Sequence Diagram

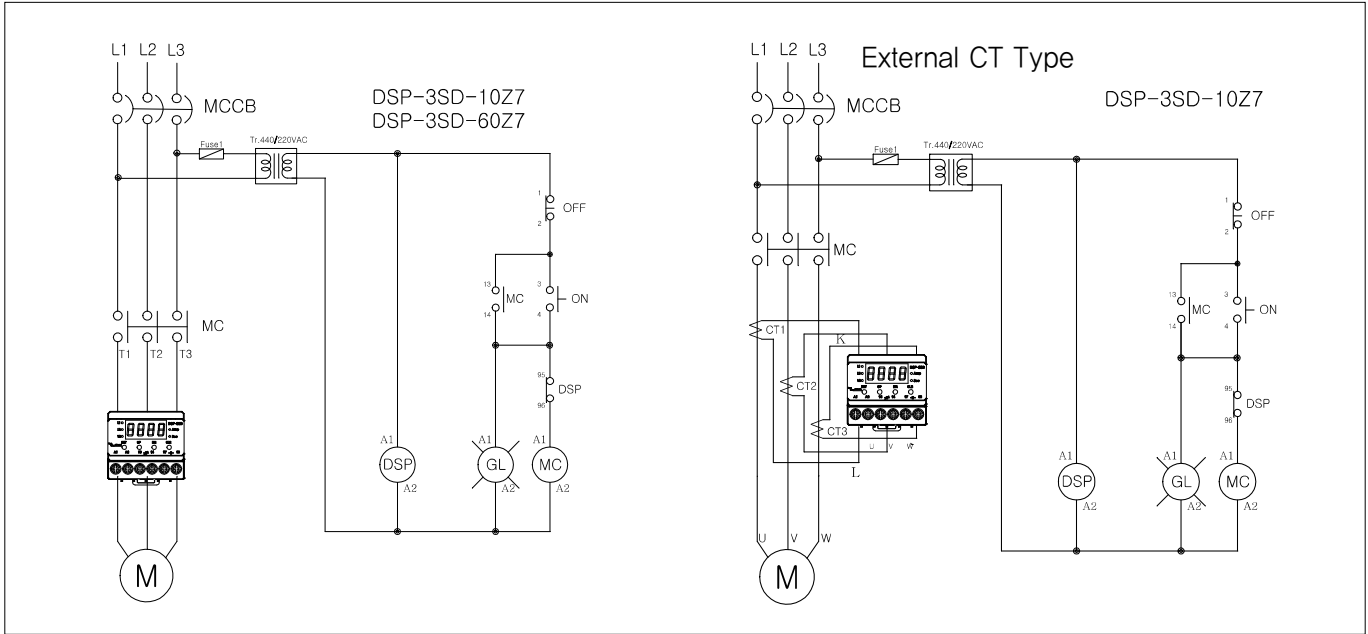

## Dimension

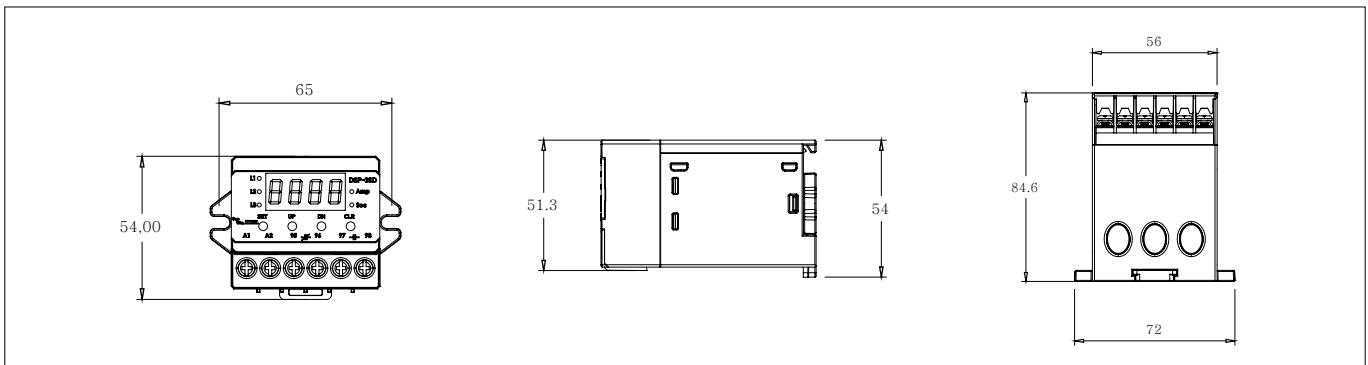

## Order Form

No.	Feature	Description
1	Type	<ul style="list-style-type: none"> <li>▶ DSP-3SD</li> <li>▶ DSP-3SD-RG</li> </ul>
2	Rating Current	<ul style="list-style-type: none"> <li>▶ 10 : 0.5~10A ▶ 60 : 5~60A</li> <li>▶ Combined with external 3CT : Not available for 3SD-RG</li> <li>▶ C1 : 100/5 ▶ Cc : 150/5 ▶ C2 : 200/5 ▶ C3 : 300/5 ▶ C4 : 400/5</li> </ul>
3	Control Power	<ul style="list-style-type: none"> <li>▶ B : DC24V/Optional</li> <li>▶ Z7 : 100~240VAC, 50/60Hz(120~370VDC) / Standard</li> </ul>
4	P	<ul style="list-style-type: none"> <li>▶ NIL : Standard Type</li> <li>▶ P : Customized Type</li> </ul>
eg.	DSP-3SD-10-Z7	Panel Mounting Type, 0.5A~10A, 100~240VAC, 50/60Hz (120~370VDC), able to use external CT
	DSP-3SD-RG-60-Z7	Panel Mounting Type, 5A~60A, 100~240VAC, 50/60Hz(120~370VDC), GF protection : 0.5A~10A/ sensed in residual circuit, not available for external CT